

multiPIPE

Wireless RF Programmable Thermostat & Receiver  
Model: 22-99908



Quick Guide Installation

Technical  
T: 01245 850799 E: technical@multiPIPE.co.uk www.multiPIPE.co.uk

22-99908 Quick Guide

**Introduction**  
The 22-99908 thermostat will switch your heating system on or off, as needed, in accordance with the temperature set by you. The package includes the following products:

- Thermostat
- Receiver
- 2 x AA Batteries

**Product Compliance**  
EU Directives: 2014/53/EU  
2011/65/EU.  
(G) 868.0-868.6MHz; <13dBm

**Safety Information**  
Use in accordance with the EU and national regulations. For indoor use only.  
Keep your device completely dry. This product must be installed by a competent person and in accordance with all the EU and national regulations.

 Always isolate the AC Mains supply before installing or working on any components that require 230 VAC 50Hz supply.

Installation

Thermostat and Receiver

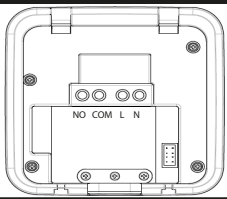
Terminal	Description	Receiver Terminals
NO	Switch Terminal	
COM	Common Switch Terminal	
L	Mains Live (230VAC)	
N	Mains Neutral	

 Remove the thermostat link wire in the boiler, if required. Please refer to manufacturer instructions.

1. Wire up the receiver and switch the power on. The Red LED will flash.

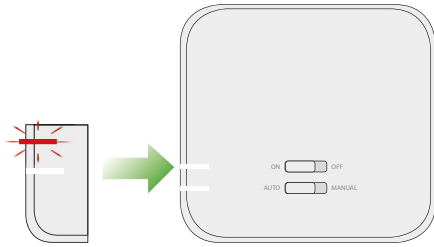

2. Once the receiver is switched on, insert the batteries into the thermostat. The devices are already prepared.  
Now follow Test pairing process to confirm connection between both the thermostat and receiver.



Test Pairing

A. Begin the Test Pairing process

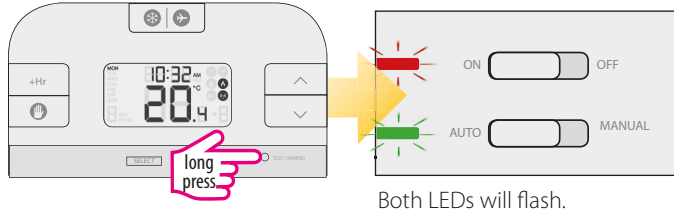

B. End the Test Pairing process

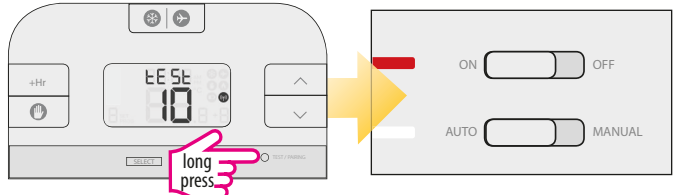

After the Test Pairing Mode, the LED should turn solid Red.  
In case the LED doesn't turn solid Red, please follow the Pairing Process.

Dip Switch Settings

The DIP switches are found on the rear of your thermostat and can be used to change the span (temperature accuracy) of your thermostat from the default +/-0.5°C to +/-0.25°C and the programmes 5-2 or 24h. Changing DIP Switch 2 may cause your boiler to operate more frequently. The DIP switches are located on the back of the thermostat.

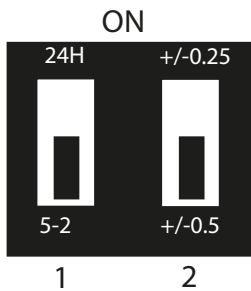

Thermostat Button Functions

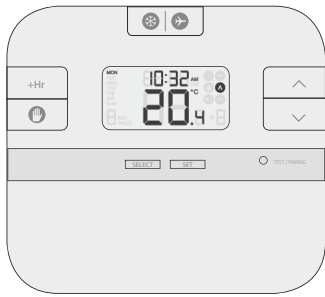

Key	Function
	1. Press once to activate Frost Mode 2. Press for 3 seconds in order to activate Holiday Mode.
+Hr	Press once to activate/deactivate Boost function
	Press once to enter/exit Permanent Override function.
^	Increase button
v	Decrease button
SELECT	Select the clock or programme settings
SET	Press to confirm your settings
○	1. Press once to enter/exit in Test Mode 2. Press for 3 seconds to enter/exit Pairing Mode 3. Press once to return to Factory Settings
+ ^ + v	Press the buttons for 3 seconds to enter Installer Mode
SELECT + SET	Press the buttons for 3 seconds to enter Clock Settings

Buttons description

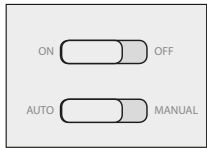

Button	Function
ON	The receiver is enabled, ready for use.
OFF	The receiver is disabled, will not function.
AUTO	The receiver will switch on and off automatically, as operated by the thermostat.
MANUAL	Providing ON is selected, the receiver will switch on continuously, overriding the thermostat.

Installer Mode

Press the three buttons together for 3 seconds.

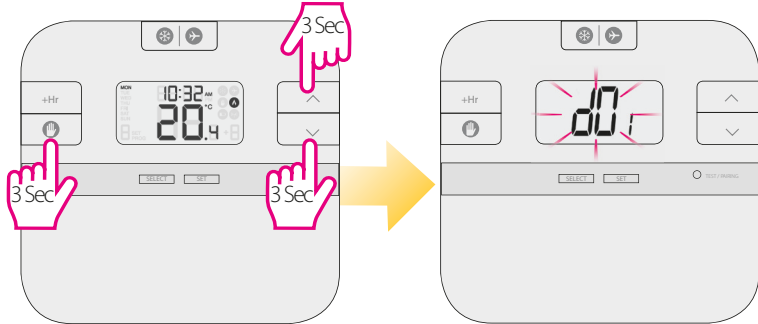

Now use the ^, v and SET buttons to make the adjustments.

dxx	Function	Parameter	Description	Default value
d01	Temperature display increments	0.1 or 0.5°C	Select temperature display increments	0.5°C
d02	Temperature offset	+/-3.0°C	Calibrate your thermostat temperature	0.0°C
d03	Frost setpoint	5.0-17.0°C	Set the Frost Point temperature	5.0°C

Pairing Process

Begin the pairing process

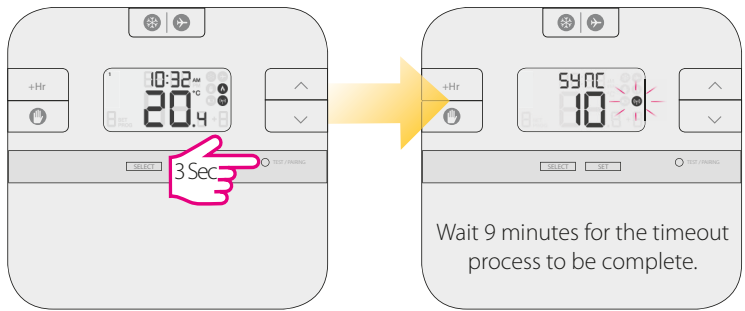

End the pairing process

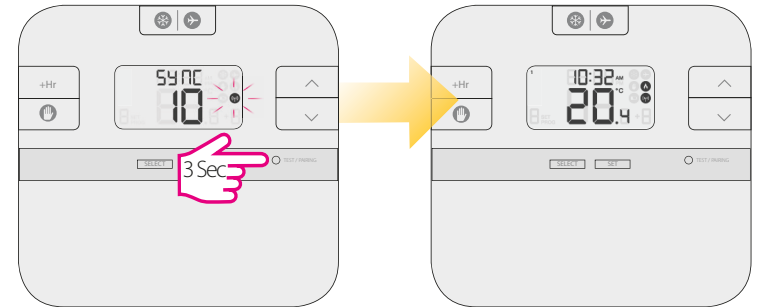

Once the LED stops flashing, press the TEST / PAIRING button for 3 sec.

### Setting Time and Date

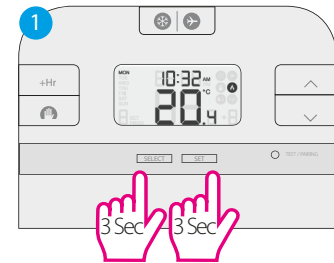

Press the buttons together for 3 sec.

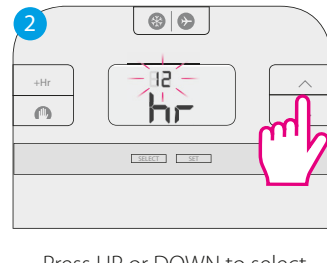

Press UP or DOWN to select the hour format and then press SELECT to confirm your option.

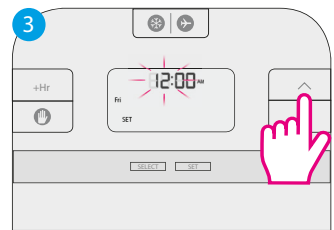

Press UP or DOWN to select the hour and then press SELECT to confirm your option.

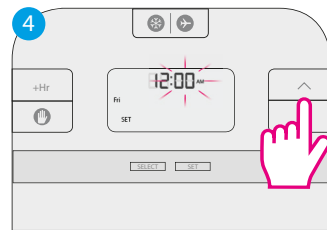

Press UP or DOWN to select the minutes and then press SELECT to confirm your option.

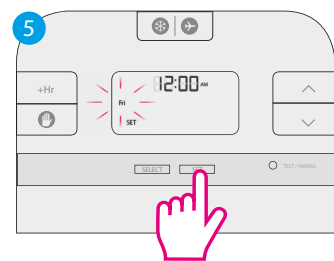

Press SET to return to the Main Screen.

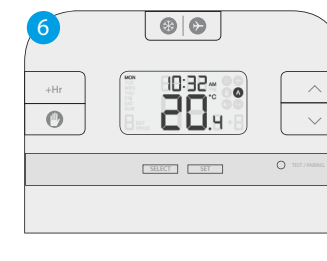

Continue with the same steps for setting the Day.

### Programming

You can create personalized programmes for your controller. You have the option to choose between a 5-2 days programme or a daily one by using the DIP Switches.

**i** Please move the DIP Switch to 24h in order to have the individual programme active. After that please follow the same instructions as for the 5-2 days programme.

5-2 Days Programme	24h Programme
Weekdays 6 sets of time/channel Weekends 6 sets of time/channel	24h 6 sets of time/channel
Total: 12 settings/week	Total: 42 settings/week

### Temporary Override

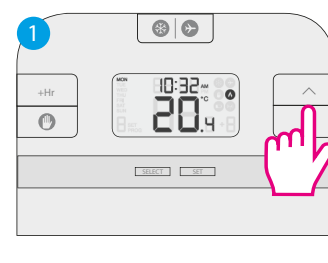

Press UP or DOWN to review the setpoint temperature.

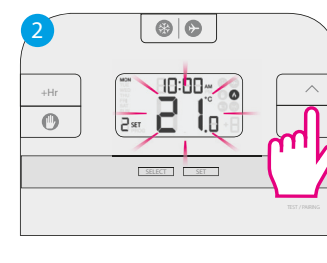

Press UP or DOWN to set the temperature.

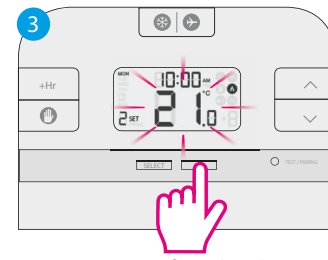

Press SET to confirm the changes.

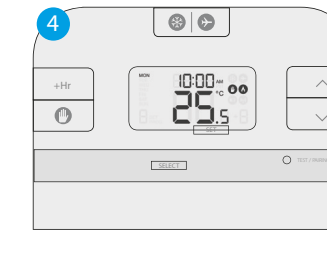

Press UP or DOWN to set the temperature.

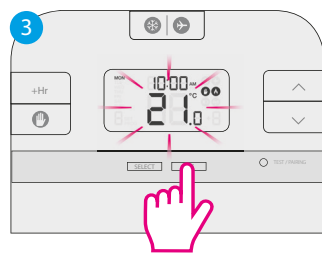

Press SET to confirm the changes.

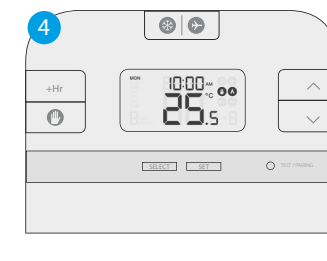

The Override sign will appear on the Main screen.

### Boost function

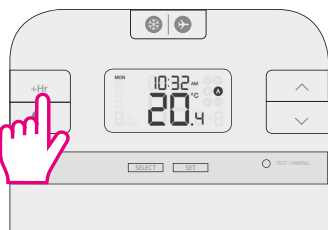

Press +Hr to activate the Boost function.

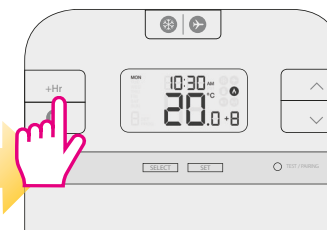

Press +Hr to set boost hours and then press UP or DOWN to set the boost temperature for your boost period.

### Review the Setpoint (desired) temperature

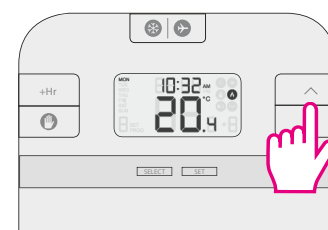

Actual room temperature

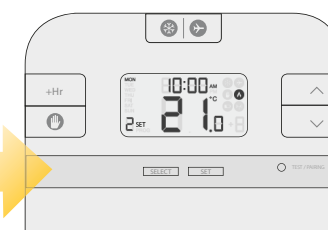

Setpoint (desired) temperature

### Frost protection

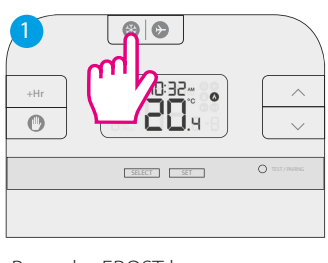

Press the FROST button once to activate the function.

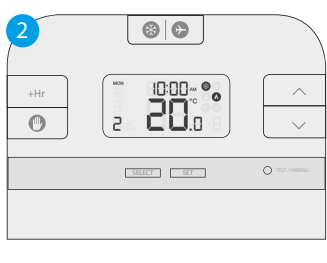

Frost Mode ON.

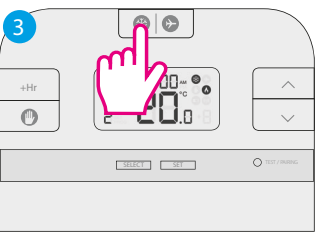

Press the FROST button once to deactivate the function.

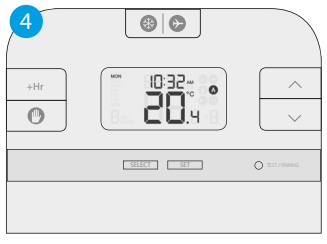

Frost Mode OFF.

**i** The Frost protection temperature can be reviewed by pressing the UP button once, but can only be changed in Installer Mode.

### Holiday Mode

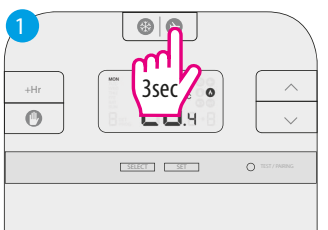

Press the HOLIDAY button for 3 sec.

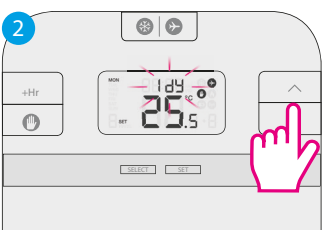

Press the UP or DOWN button to set the Holiday period.

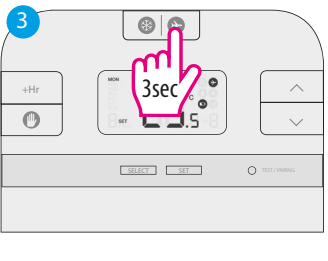

Press the HOLIDAY button for 3 sec to exit Holiday Mode.

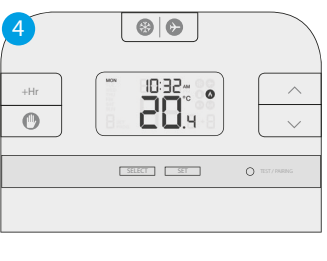

**i** You can also exit Holiday Mode by setting the days to zero.

### Thermostat RESET Function

Remove the batteries without pressing any button. Wait 2 minutes and insert the batteries again. Your device will be restarted.

**i** When you want to change the batteries your device will use the internal memory to backup your settings. You have 30 seconds to change the batteries before losing your settings.